



7" PLANK QUICK START INSTALLATION GUIDE

IMPORTANT: Failure to follow Alside written installation instructions and comply with applicable building codes may violate laws and affect siding performance and void warranty coverage.

ASCEND serves as a supplemental rain screen, not a weather-resistant barrier. ASCEND must be installed over a weather-resistant barrier system in accordance with local building code.

For complete installation instructions, visit alside.com/ascend.

STARTER STRIP

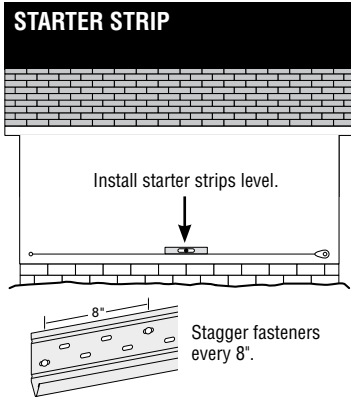

OUTSIDE CORNER POST

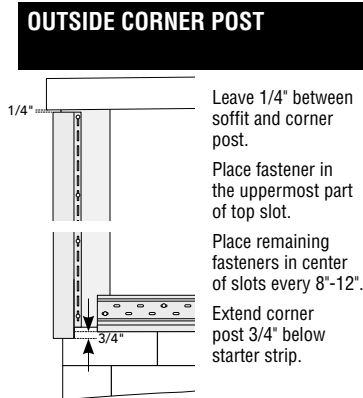

TOOLS AND BLADES

VERTICAL CUTS [IMPORTANT]: Must be straight. Circular saw with a diamond blade or fine tooth (plywood) blade installed backward.

Tin snips; avoid closing blade completely at end of each stroke for a cleaner cut.

HORIZONTAL CUTS

Angle grinder with grinder blade.

Utility knife or scoring tool; score across and through the face of plank, into foam backing, and snap in half.

ANGLE CUTS

Saws, snips and grinder blades are acceptable.

FASTENING – LOWER COURSE AT OVERLAP

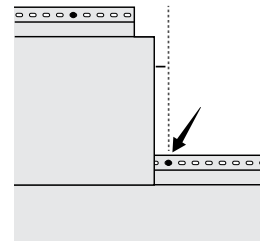

Place a fastener on lower course in nail slot closest to plank overlap. **[IMPORTANT]:** See full installation instructions for further details.

PLANK OVERLAP

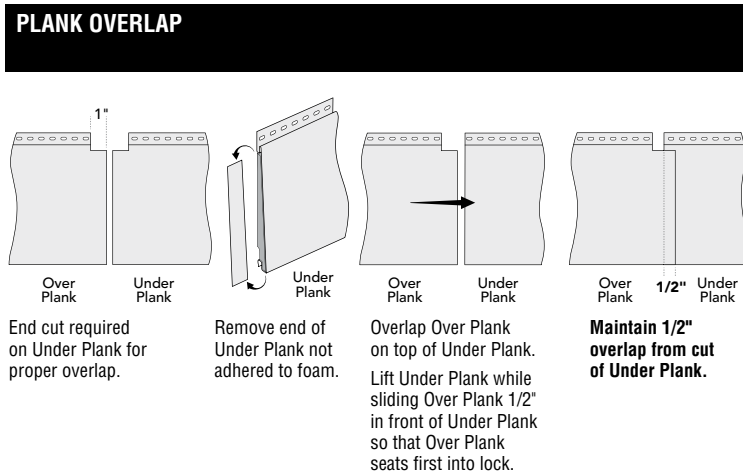

CLEARANCE BETWEEN PLANK AND RECEIVING CHANNELS

Allow gap between planks and channeled accessories:

Ensure 3/8" gap between planks and all channeled accessories or obstacles.

Remove end of plank not adhered to foam before inserting into channel.

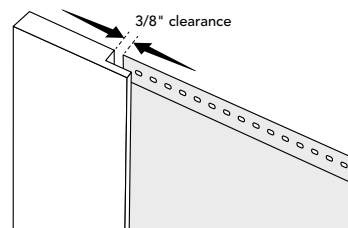

FASTENING

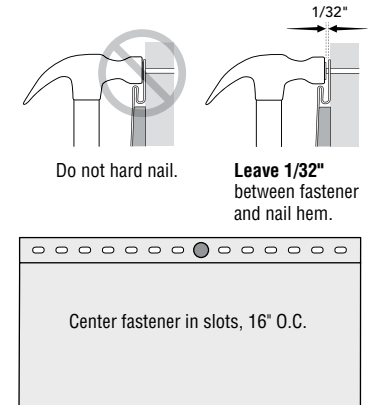

STACK LOCK ENGAGEMENT

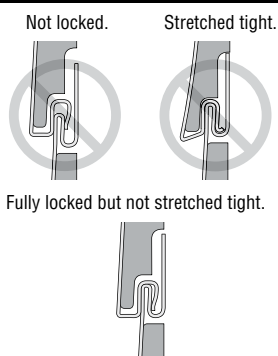

PLANK RIP CUTS BELOW OBSTACLES

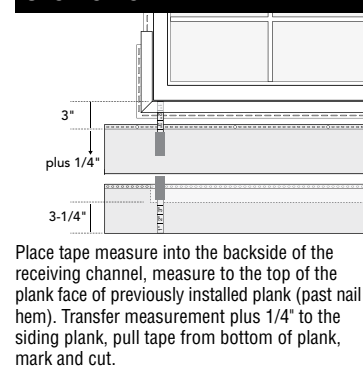

PLANK RIP CUTS ABOVE OBSTACLES

Hook tape measure onto the backside of the receiving channel, measure to the top of the plank face (past nail hem) of previously installed plank. Transfer measurement plus 3/4" to the siding plank, pull tape from bottom of plank, mark and cut.

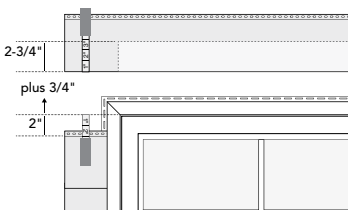

FINISH TRIM – SECURING PLANK RIP CUTS

Use anytime the top nail hem or bottom stack lock of plank has been removed.

Insert into the sill and header receiving channel.

Receiving channel is installed prior to finish trim and measurements for plank cuts.

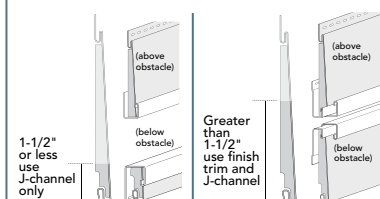

Alside 3773 State Road Cuyahoga Falls, Ohio 44223
1-800-922-6009 www.alside.com





GUÍA DE INSTALACIÓN DE INICIO RÁPIDO DE TABLÓN DE 7"

IMPORTANTE: No cumplir con las instrucciones escritas de instalación de Alside ni cumplir con los códigos de construcción aplicables puede violar las leyes y afectar el rendimiento y anular la cobertura de garantía.

ASCEND sirve como una pantalla contra la lluvia adicional, no como una barrera impermeable. ASCEND debe instalarse sobre un sistema de barrera resistente al clima de acuerdo con el código residencial local.

Para obtener instrucciones completas de instalación, visite alside.com/ascend.

BARRA DE INICIO

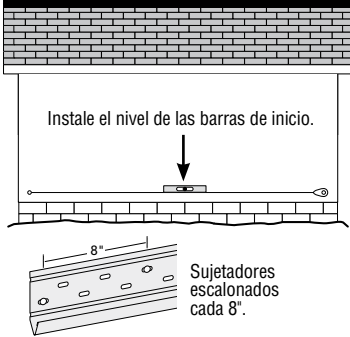

POSTE DE ESQUINA EXTERIOR

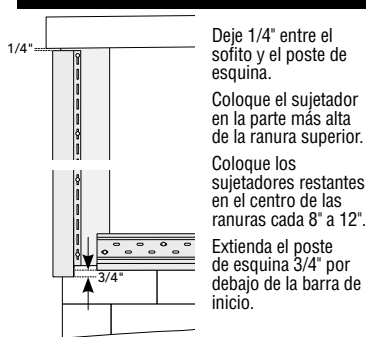

HERRAMIENTAS Y CUCHILLAS

CORTES VERTICALES [IMPORTANTE]: Debe estar recto. Sierra circular con hoja de dientes finos (madera contrachapada) instalados hacia atrás.
Tijeras de estaño. Evite cerrar la cuchilla completamente al final de cada trazo para un corte más limpio.
CORTES HORIZONTALES Esmeriladora angular con cuchilla esmeriladora.
Navaja multiusos o herramienta de marca. Coloque marcas en la cara del tablón, en el soporte de la espuma y divida a la mitad.
CORTES EN ÁNGULO Se aceptan sierras, tijeras y cuchillas de esmeriladora.

SUJECIÓN – CURSO INFERIOR EN TRASLAPE

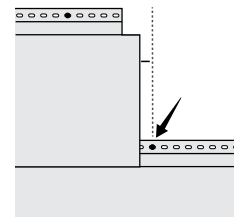

Coloque un sujetador en la hilera inferior en la ranura para clavos más cercana a un traslape del tablón. **[IMPORTANTE]:** Consulte las instrucciones de instalación completas para obtener más detalles.

TRASLAPE DE TABLONES

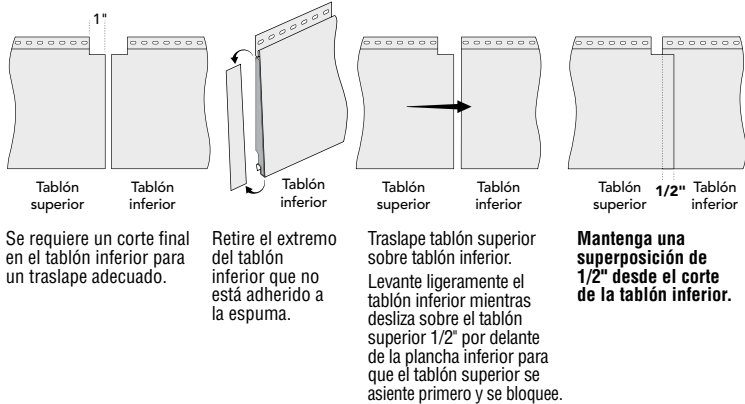

DISTANCIA ENTRE EL TABLÓN Y CANALES RECEPTORES

Deje un espacio entre los tabloneros y los accesorios canalizados: Asegúrese de que haya un espacio de 3/8" entre las tablas y todos los accesorios u obstáculos canalizados. Retire el extremo de la plancha que no está adherido a la espuma antes de introducirlo en el canal.

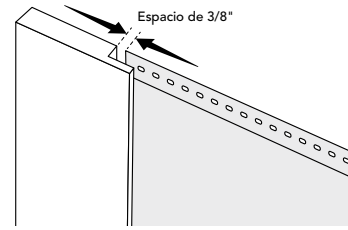

SUJECIÓN

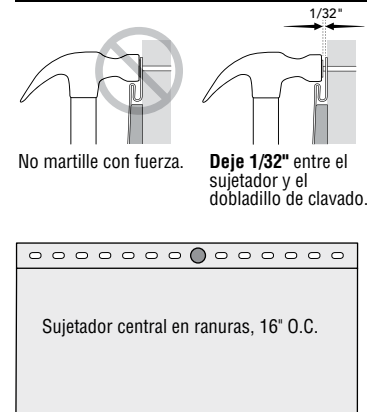

ENGANCHE DE BLOQUEO

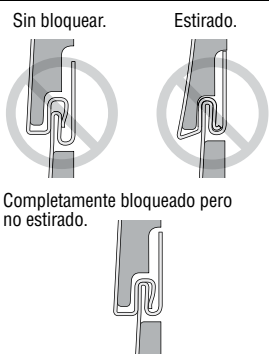

CORTES DE TABLÓN DEBAJO DE OBSTÁCULOS

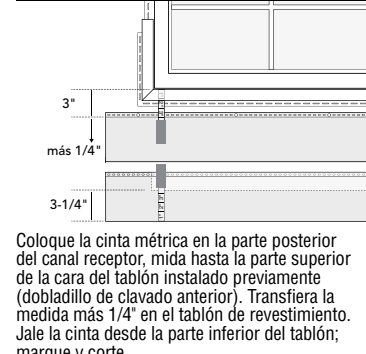

CORTES DE TABLÓN ENCIMA DE OBSTÁCULOS

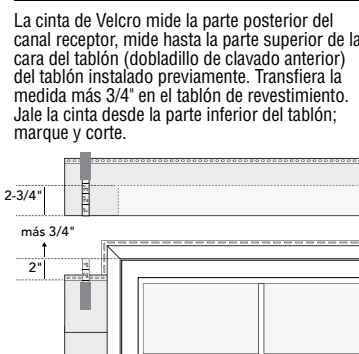

ACABADO DE MOLDURA - ASEGURE LOS CORTES DE LOS TABLONES

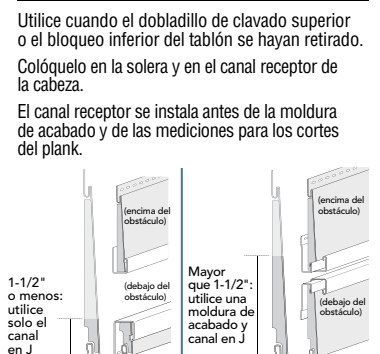

Alside 3773 State Road Cuyahoga Falls, Ohio 44223
1-800-922-6009 www.alside.com

